



SubPrimo Acoustic underlay for timber and laminate floors

High Performance solution for impact noise

SubPrimo Datasheet

- ✓ **Significantly reduces impact noise transmission from laminate, engineered and solid wood floor finishes**
- ✓ **Easy to install**
- ✓ **Minimal thickness**
- ✓ **Extremely durable**
- ✓ **Can be used with a Maxi60 ceiling for enhanced compliance with building regulations**

Introduction

Sound Reduction Systems Ltd. (SRS) manufacture acoustic insulation and absorption products for use in domestic and commercial buildings. Over 25 years experience in the building acoustics industry ensures that our team of qualified acousticians can offer honest, practical advice and effective solutions to any acoustic challenge. SRS have products and systems designed to reduce the transmission of sound through any part of a building. Please contact us should you require further information or advice.

SubPrimo

SubPrimo is an acoustic underlay product, specifically designed for use beneath timber floor finishes such as laminate, engineered and solid wood. The current trend of replacing carpet and underlay with timber flooring in flats and apartments can cause serious problems for downstairs neighbours, and many leases prohibit their installation without taking acoustic insulation into account. Within a single dwelling, sound insulation between, say, a bedroom and a sitting room can be a serious issue. SubPrimo offers the most effective method of improving the impact sound insulation of a timber floor.



Performance

SRS products are always assessed in 'real world' situations. Because SubPrimo is to be used under a hard floor finish SRS have elected to demonstrate a comparison of a typical bare floor to one with SubPrimo and a laminate floor, using the same procedure as for current building regulations. Measurements made to ISO 140-8 (ΔL_w dB) crucially do not include the floor finish and can be misleadingly optimistic.

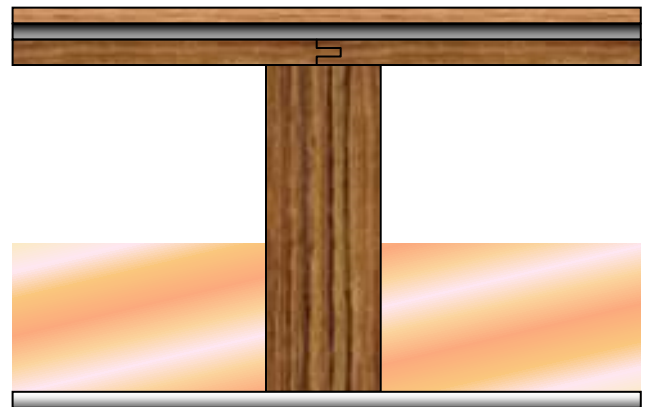

SubPrimo 'On Site' data

| | Airborne $D_{nT,w} + C_{tr}$ dB | Impact $L_{nT,w}$ dB |
|-------------------------|------------------------------------|-------------------------|
| Bare floor | 38 | 78 |
| + SubPrimo and Laminate | 43 | 68 |

Acoustic tests on SubPrimo carried out independently by Noise Control Services, 12/04/06, in accordance with ISO 140 parts 4 and 7. Rated to ISO 717 parts 1 and 2. Test reference numbers: NCS 40603/1-4. Bare floor consisted of 18mm chipboard on 225 x 50mm timber joists with 100mm mineral wool infill and a single layer of directly fixed 12.5mm plasterboard ceiling.

In summary, SubPrimo reduces airborne noise transmission by 5dB and impact noise transmission by 10dB, typically this represents a subjective perception of the noise level halving.





SubPrimo Installation

SubPrimo is supplied in 1150 x 950 x 6mm sheets, and is simply loose laid onto the existing floor in a brick pattern. SubPrimo can easily be cut and shaped using a standard trimming knife. It is important to ensure that the SubPrimo is installed tight up to or, if possible, under the skirting and that no gaps occur between the sheets as they are installed.

The timber floor finish is then installed directly onto the SubPrimo, as with conventional underlays. It is important to leave an expansion gap between any timber floor finish and the perimeter. Direct contact between the floor finish and the beading or skirting should be avoided. The skirting board should sit on a length of SRS Soundseal acoustic sealing gasket - grade 15 2/10. The Soundseal will help isolate the floor from the wall construction. As with all floating floor installations, no fixings should be allowed to penetrate the resilient layer.

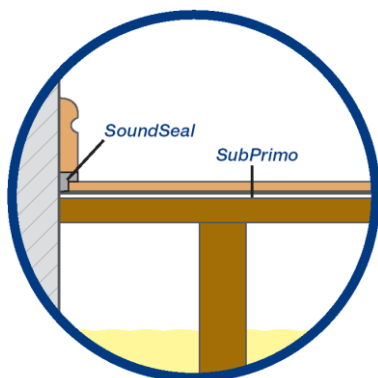

Cross section of SubPrimo beneath skirting

Dimensions:

Size = 1150 x 950mm (nominal)

Thickness = 6mm

Weight = 4kg/m²

Cutting: Best cut using a sharp trimming knife. Score the surface, then run through with the knife several times to avoid

tearing. When shaping, use large scissors or tin snips.

Storage: Must be laid flat and kept dry.

SRS Ltd Acoustic Insulation Datasheets

Sound Reduction Systems Ltd are experts in all areas of sound insulation. For further information on our range of products and systems for reducing sound transmission in buildings and meeting the acoustic requirements of the Building Regulations Approved Document E, please see the following datasheets, which are easily obtained by calling **01204 380074** or downloading from www.soundreduction.co.uk.

Ceilings Datasheets:

- Maxiboard beneath existing plasterboard / lath and plaster
- Maxiboard on a British Gypsum MF ceiling
- Maxiboard beneath concrete beam and block

Walls Datasheets:

- Maxi HP Partition System
- Maxiboard installed with new/existing stud
- Maxiboard installed on new/existing masonry

Floors Datasheets:

- Acoustilay • Maxideck

Free, Friendly Advice

If you are unsure of which product or system you require, please contact our industry leading technical department on Tel: **01204 380074** or email info@soundreduction.co.uk.



SubPrimo installed on a floor



sound
reduction
systems

Manufacturers of Acoustic Insulation Products

Sound Reduction Systems Ltd
Adam St, Off Lever St, Bolton BL3 2AP
Tel: +44 (0)1204 380074 · Fax: +44 (0)1204 380957
E-mail: info@soundreduction.co.uk
Web: www.soundreduction.co.uk