

Uniclass L5395:N372	EPIC E485:Y45
CI/SfB (43)	X (P2)



**maxideck**

**High Performance  
Acoustic Flooring  
Solution**



**sound**  
reduction  
**systems**

Manufacturers of Acoustic Insulation Products



# Introduction

## Introduction

Maxideck is a high performance acoustic flooring solution, designed to comply with Building Regulations Part E. Ideal for conversion or newbuild projects, Maxideck is a cost effective and time efficient method of exceeding both the airborne and impact noise standards in many different constructions. Maxideck is also ideal for customers who are simply looking to upgrade the sound insulation of their own properties.

Maxideck is an extremely versatile product, and can be used in all areas. The use of a moisture resistant material on the upper face ensures the product can be installed in both kitchens and bathrooms.

## Benefits

- ✓ High levels of airborne & impact insulation
- ✓ Can comply with Part E
- ✓ Great for refurb and conversion projects
- ✓ Suitable for Newbuild
- ✓ Easy to install
- ✓ Minimum increase in floor height - only 28mm thick
- ✓ Available through SRS' nationwide distributors
- ✓ Can be used in Kitchens & Bathrooms

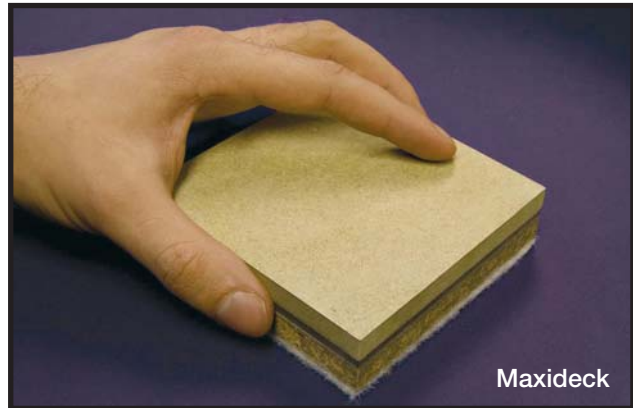

Maxideck

## Installation

*NOTE: SRS Ltd advise that for best results Maxideck is installed above a ceiling comprising two layers of plasterboard on resilient bars, with 100mm dense mineral fibre between the joists. The direct fix result is given as information only, for those people who already have a ceiling in place. If you must install Maxideck above an existing ceiling, it may need upgrading. SRS suggest 2 layers of plasterboard, with a minimum mass per square metre of 20kg/m<sup>2</sup>, and 100mm of dense mineral fibre in the cavity, as a minimum requirement.*

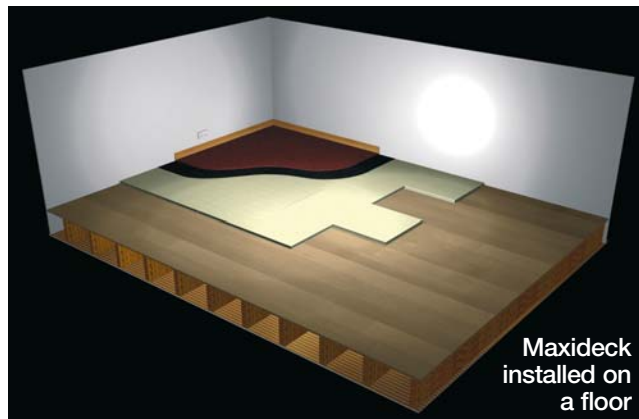

Maxideck installed on a floor

The existing floor surface should be dry and free from debris before installing the Maxideck. If the existing floorboards have gaps between them, they must be filled with a flexible sealant. The Maxideck is fitted in a brick bond pattern, with the felt facing down.

Where the Maxideck meets the skirting boards at the perimeter walls, the overlap on the top board of the Maxideck should be removed. In order to isolate the boards from the skirting, and allow for any expansion that might occur, the self adhesive 25mm 5/26 Maxideck Edging Strip should be applied directly to the trimmed edge of the board. This enables the installer to locate the boards easily, leaving a 10mm expansion gap, which the Soundseal will expand to fill. Please note that the rate of expansion varies

# Maxideck Installation

depending on site conditions - a period of 24hrs should be allowed for full expansion.

If fitting skirting boards after the Maxideck has been installed, you must use the wider 32mm 5/26 Maxideck Edging Strip on the boards that meet the perimeter walls. The excess Edging Strip expands over the top of the Maxideck and provides the installer with a resilient base to sit the skirting on.

Once fully installed, the Maxideck can be treated as a standard timber floor finish, however, please refer to manufacturers instructions before installing any decorative floor finish.

All Maxideck joints are to be glued with SRS Gripfix. Joints are then screw fixed using 20 x 3.5mm, countersinking screws. Two

screws are recommended along each long edge of the individual boards, 100mm either side of the joint in the previous row. The SRS Gripfix will achieve full bond strength after 24 hours cure. It is essential that screw fixings do not penetrate the felt layer – no screws longer than 20mm should be used.

Should you need to cut a hole in the Maxideck to accommodate any pipework, you should use the correct sized hole saw to remove the section of Maxideck. Another section of Maxideck, from the hole to the edge of the board, should be then be removed using a hand saw or jigsaw to allow the service/pipe to be located in the board – this piece should be retained. Once the pipe is in place, the retained section can be glued back into position using SRS Gripfix. SRS Acoustic sealant can be used to fill any gap between the pipe and the Maxideck.

## Acoustic Data

### Acoustic Performance - Directly Fixed Ceiling

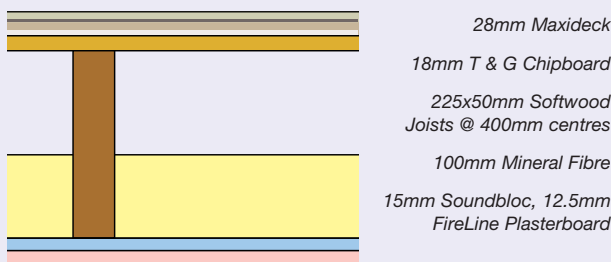

When tested to BS EN ISO 140 Part 4 and rated to BS EN ISO 717 Parts 1&7 the test results were:

Maxideck installed above a double boarded ceiling			
	$D_{nTw}$	$D_{nTw} + C_{tr}$	$L_{nTw}$
	50dB	44dB	61dB

Tests carried out by Soundtesting.co.uk on 13<sup>th</sup> July 2007:  
Airborne test number: 1402-1, Impact test number: 1402-2

### Acoustic Performance - Resiliently Fixed Ceiling

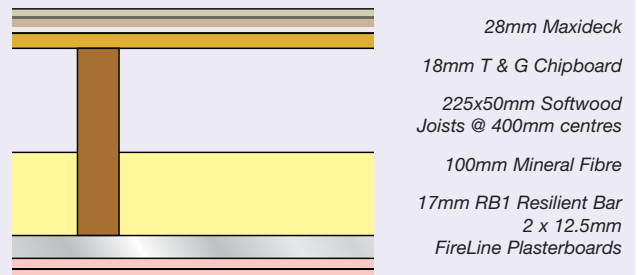

When tested to BS EN ISO 140 Part 4 and rated to BS EN ISO 717 Parts 1&7 the test results were:

Maxideck installed above a double boarded ceiling on resilient bars			
	$D_{nTw}$	$D_{nTw} + C_{tr}$	$L_{nTw}$
	60dB	52dB	52dB

Tests carried out by Noise Control Services on 19<sup>th</sup> April 2007.  
Test Reference No. NCS/050705/8

**Storage:** Maxideck must be laid flat and kept dry. Maxideck should only be stored on site if the building has been sealed and is completely dry.

**Cutting:** Maxideck is best cut using a circular saw with dust extraction fitted, however, it can also be cut using a handsaw or a jigsaw with a heavy duty blade fitted for small areas.

**Distributor map and contact details on reverse of brochure.**

**Maxideck Dimensions:** Size: 1200 x 600mm (Nominal), Thickness: 28mm, Weight: 27 kg/m<sup>2</sup>

**Maxideck Accessories:** SRS Gripfix = 310ml Tube  
SRS Acoustic Sealant = 900ml Tube  
25mm Wide Maxideck Edging Strip 5/26 (For use if skirting already installed)  
32mm Wide Maxideck Edging Strip 5/26 (For use if installing skirting on to Maxideck)

# Distributor Network

## A The Spectra Group

Duchess Estate, Sievewright Street,  
Rutherglen, Glasgow G73 1LL

Contact: Bill Smyth

T: 0141 6470831 F: 0141 6430047  
M: 07860 104405  
E: office@spectragroup.co.uk  
W: www.spectragroup.co.uk

## B Commercial Connections

37 Ballywillin Road, Crossgar,  
Co. Down BT30 9LE

Contacts: James Reynolds,  
Robert Johnston, Gareth Chambers

From UK

T: 028 4483 1227 F: 028 4483 2747

From Eire

T: 048 4483 1227 F: 048 4483 2747

E: info@commercialconnections.co.uk

W: www.commercialconnections.co.uk

## C Floorscan Acoustics & Contracts Ltd (West)

44 Canal Street, Bootle,  
Liverpool L20 8QU

Contact: John Howell

T: 0151 9330939 F: 0151 9339733  
M: 07739 262406  
E: john@floorscan.co.uk  
W: www.floorscan.co.uk

## D Floorscan Acoustics, East

Unit 5, Tranself Industrial Estate,  
Colonels Walk, Pontefract,  
West Yorkshire WF8 4PJ

Contact: Alan Randall / Dan Sulley

T: 01977 799252 F: 01977 791056  
M: 07791 563688  
E: acoustar@aol.com

## I Exton Construction Supplies Ltd

2 Solent Industrial Estate,  
Shamblehurst Lane, Hedge End,  
Southampton, Hampshire SO30 2FX

Contacts: Bob May, Richard Gray

T: 01489 788909 F: 01489 788911  
E: sales@extonconstructionsupplies.co.uk  
W: www.extonconstructionsupplies.co.uk

## E Trim Acoustics Midlands

Albion Road, West Bromwich,  
West Midlands B70 8BA

Contact: Dennis Gwilliam

T: 0121 553 4098 F: 0121 525 9399  
M: 07860 966 860  
E: wb.sales@trimacoustics.co.uk  
W: www.trimacoustics.co.uk

## F Trim Acoustics Enfield

Unit 38, Redburn Industrial Estate,  
Woodall Road, Enfield, Middlesex EN3 4LE

Contact: Richard Groborz

T: 020 8443 0099 F: 020 8443 1919  
M: 07889 177688  
E: sales@trimacoustics.co.uk  
W: www.trimacoustics.co.uk

## G Trim Acoustics New Malden

Unit 6, Wyvern Estate, New Malden,  
Surrey KT3 4PH

Contact: John Robinson

T: 020 8336 6229 F: 020 8336 1414  
M: 07855 422840  
E: sales@trimacoustics.co.uk  
W: www.trimacoustics.co.uk

## H Trim Acoustics South West

Unit 12a, Lynx Crescent,  
Weston-Super-Mare BS24 9DJ

Contact: Mike Campion

T: 01934 625107 F: 01934 625170  
M: 07860 966785  
E: sales@trimacoustics.co.uk  
W: www.trimacoustics.co.uk

\* Please note that any of the Trim Acoustics Branches are able to provide prices and answer technical enquiries on behalf of another Branch.



sound  
reduction  
systems

Manufacturers of Acoustic Insulation Products

Sound Reduction Systems Ltd

Adam St, Off Lever St, Bolton BL3 2AP

Tel: +44 (0)1204 380074 · Fax: +44 (0)1204 380957

E-mail: info@soundreduction.co.uk · Web: www.soundreduction.co.uk

Site conditions and installation standards vary. SRS cannot take responsibility for the performance of any installed system of which SRS products are only a part, or that have been installed incorrectly. Prior to installation, it is necessary to identify and eliminate possible flanking paths that may compromise the acoustic performance of any SRS product.

For rapid delivery of  
Acoustilay & Maxiboard,  
customers may order from  
the stockist who covers  
their area.